

TOWN OF BRISTOL
Application for Driveway Access Permit to a Town Highway

Parcel ID#: 020135.1 Application #: _____

Related Zoning or Subdivision Permit (if any): _____

Land Owner: Wilma Wood Telephone: 802-453-7228

Mailing Address: P.O. Box 63 Bristol UT, 05443

Applicant Name: Wilma Wood Telephone: 453-7228

Mailing Address: P.O. Box 63 Bristol VT

Town Road Name Handscabble Rd Town Highway # _____

Road Frontage of Parcel (number of feet.): 180.5

Proposed Use of Driveway (check all that apply):

- [] Agricultural [x] Single Residence [] Commercial
[] Relocation [] Change of Use [] Shared Residential Driveway or
[] Other: _____ Development Road (# Parcels _____)

Describe the exact location of the proposed driveway access (distance from property lines, distance to nearby landmarks, etc.):

West Side of Lot
Approx 110 FT length

Please provide a sketch on a separate sheet of paper of the parcel and road frontage indicating the location of the proposed driveway access, other existing accesses, the Town Highway, buildings, drainage ditches, fences, utility poles, and trees or plantings that may impair visibility, etc.

The applicant agrees to maintain said access and to adhere to the conditions attached to this permit. In the event all conditions of the access permit are not met within one year the town shall be authorized to affect those conditions at the landowner's expense.

I represent that the information contained in this application is true and that I am authorized to file this application.

Landowner Signature: Wilma Wood Date: 6-26-18

Applicant Signature: Wilma Wood Date: 6-26-18

For Town Use:

Date Received: 6.26.18 Fee Paid: \$50.- / #576

Reviewed by ^{Act.} Road Foreman: Cate Pelland Date: 7.19.18

Action by Selectboard:
 Approved Denied Date: _____

Conditions of approval:

- Need 15" culvert 30' long C.P. act. Foreman
- Cut brush between driveway and barn
- Remove brush on east side of drive
- All brush removed needs to continue to be maintained by land owner.
- Grade of driveway cannot be more than 2% where it intersects town highway.

Authorized Signature: _____ Title: _____

Parcel 1A 020135.1 - Handscabble Rd.

Handscabble Woods / Wilma Wood

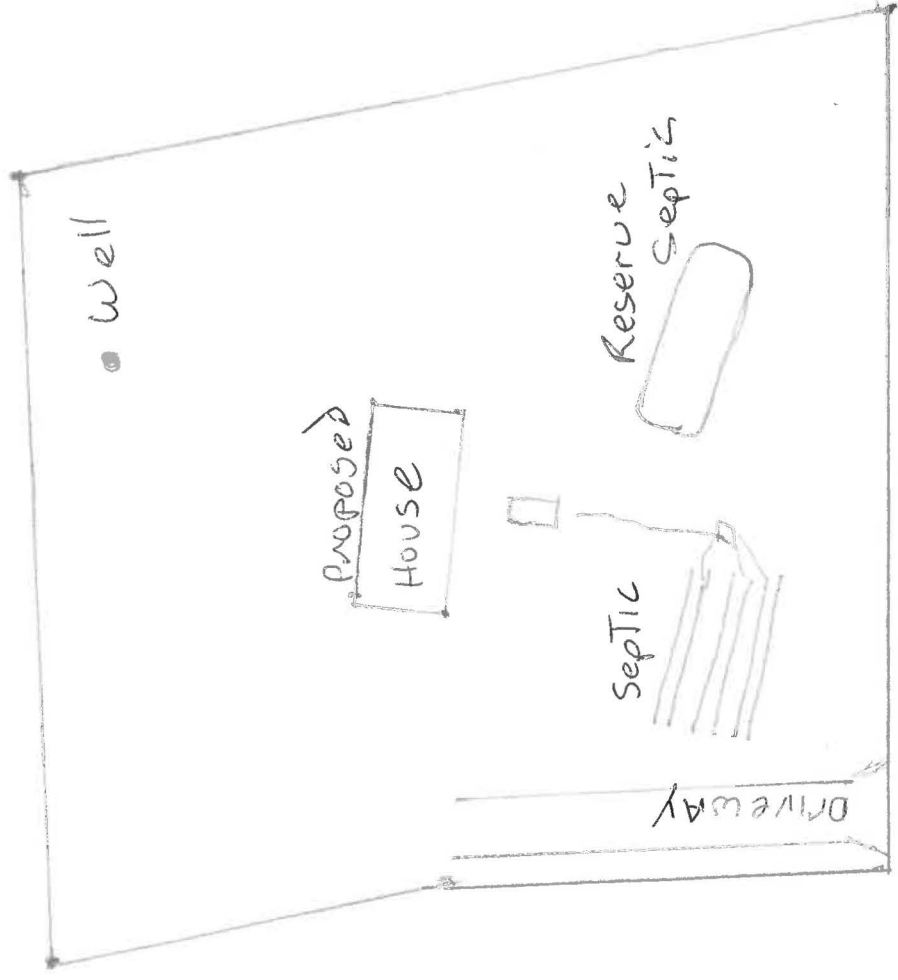

580 Handscabble Rd.

Handscabble Rd